

Standard vibrationsdæmpere

Dimensioner

Type 2

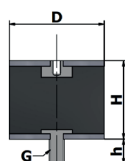

D	H	G
6	7	M3xh/M3
8	5	
8	8	M3xh/M3
8	10	
9	12	M3xh/M3 M4xh/M4
10	8	M3xh/M3
10	10	M4xh/M4
10	15	M3xh/M3
10	17	M4xh/M4
10	18	M5xh/M5
10	30	
11	11	M3xh/M3 M4xh/M4
12	10	M3xh/M3 M4xh/M4
13	26	M4xh/M4 M5xh/M5 M6xh/M6
15	4	
15	5	
15	6	
15	7	
15	8	M4xh/M4
15	9	
15	10	M4xh/M4
15	12	M5xh/M5
15	13	
15	15	
15	20	
15	25	
15	30	
16	18	M4xh/M4 M5xh/M5
20	5	
20	8	
20	10	M5xh/M5 M6xh/M6
20	11	M5xh/M5
20	12	M6xh/M6
20	13	
20	15	M5xh/M5
20	17	M6xh/M6
20	20	M8h/M8
20	23	
20	25	
20	30	

VIBRATIONSDÆMPERE

Dimensioner

Type 2

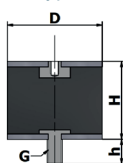

D	H	G
25	8	
25	10	
25	12	
25	13	
25	14	
25	15	M6xh/M6
25	17	M8xh/M8
25	18	
25	19	
25	20	
25	22	
25	25	
25	27	
25	28	
25	30	
26	22	M6xh/M6 M8xh/M8
30	8	
30	10	
30	12	
30	13	
30	15	M6xh/M6
30	17	M8xh/M8
30	18	M10xh/M10
30	20	
30	22	
30	25	
30	30	
30	35	
30	45	
30	40	
40	10	
40	15	M6xh/M6
40	20	M8xh/M8
40	25	M10xh/M10
40	27	
40	28	
40	30	
40	35	M6xh/M6
40	38	M8xh/M8
40	40	M10xh/M10
40	45	
40	60	
50	7	
50	9	
50	12	
50	15	
50	17	
50	20	M8xh/M8
50	21	M10xh/M10
50	25	M12xh/M12
50	27	
50	28	
50	30	
50	35	
50	37	
50	40	
50	42	
50	45	
50	50	
50	80	

VIBRATIONSDÆMPERE

Dimensioner

Type 2

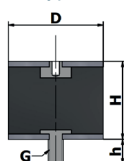

D	H	G
60	15	
60	16	
60	20	
60	25	M8xh/M8
		M10xh/M10
60	30	M8xh/M8
60	35	M10xh/M10
60	40	M12xh/M12
60	45	
60	50	
60	60	
65	35	M12xh/M12
70	20	
70	25	
70	30	M10xh/M10
70	35	M12xh/M12
70	40	
70	45	
70	50	
70	53	
70	55	
70	60	
70	70	
75	20	
75	25	M10xh/M10
75	30	M12xh/M12
75	35	
75	40	
75	45	
75	50	
75	55	
75	60	
75	70	
75	100	
80	17	M10xh/M10
80	18	M12xh/M12
80	30	M14xh/M16
80	40	M14xh/M16
80	50	
80	55	
80	60	
80	65	
80	70	
80	75	
80	80	
90	60	M12xh/M12
100	25	
100	30	
100	35	
100	40	M12xh/M12
100	45	M16xh/M16
100	50	
100	55	
100	60	
100	65	
100	70	
100	75	
100	80	
100	100	
150	50	
150	55	M16xh/M16
150	60	M20xh/M20
150	75	
200	100	M20xh/M20

Gvindlængder

G	(h) mm
M3	4, 6, 10
M4	6, 8, 10
M5	10, 12, 15
M6	6, 8, 10, 12, 15, 18, 20, 23, 28
M8	8, 10, 12, 15, 18, 20, 23, 25, 28, 33
M10	10, 12, 15, 18, 20, 23, 25, 28, 33, 38, 43
M12	10, 12, 18, 20, 23, 25, 27, 33, 37, 42
M16	26, 36, 41, 46
M20	41, 45